

# Building our Home

## THE YARD

*is the 17 acres of land God has blessed us with.*

But we have only 350 parking spots.

Concurrent to the building of our worship center, the KC will take the initiative to overhaul the entire campus to increase parking from our current 350 vehicles to over 800.

The parking initiative is currently estimated to cost \$4 million and will be raised entirely on the KC side.

## THE FAMILY ROOM

*is the space where children play, read, learn and grow. Like any other family, we want our home to be a place where our children can grow in faith.*

To this end, we plan on having the following spaces:

- Spacious Pre-K classrooms on the main floor
- A future 2nd floor entirely dedicated to Pre-K & childcare
- Dedicated Infant room
- Dedicated Toddler room
- A full court gym (jr. high size)

## THE FRONT PORCH

*is the threshold between our home and the outside world.*

We want the banner over our front porch to read: *welcome everyone in need of grace.* We want to design a home that enables us to genuinely welcome our lost co-workers, neighbors, friends and family. To this end, we will have:

- The EC overseeing all design of exterior and interior of our new home.
- Exclusive EC usage on Sunday
- Dedicated welcoming room for our guests.
- A large Fellowship Hall with full service kitchen

## THE LIVING ROOM

*is the life of the home. It is the central room, where the most important conversations with family and friends take place.*

The central room of our house will be a 450 seated, dedicated sanctuary that includes the following:

- theatre seating with sloping floors
- performance stage
- performance lighting
- glass paneled cry/nursing room

## Open Door Presbyterian Church

3001 Centreville Road  
Herndon, VA 20171

telephone (English): (703) 318-8972

telephone (Korean): (703) 318-8970

fax: (703) 318-8971

[www.odpcec.org](http://www.odpcec.org)

# Building our Home

OPEN DOOR PRESBYTERIAN CHURCH  
*Open Door Presbyterian Church*



## THE FUNDING AND DONOR PLAN

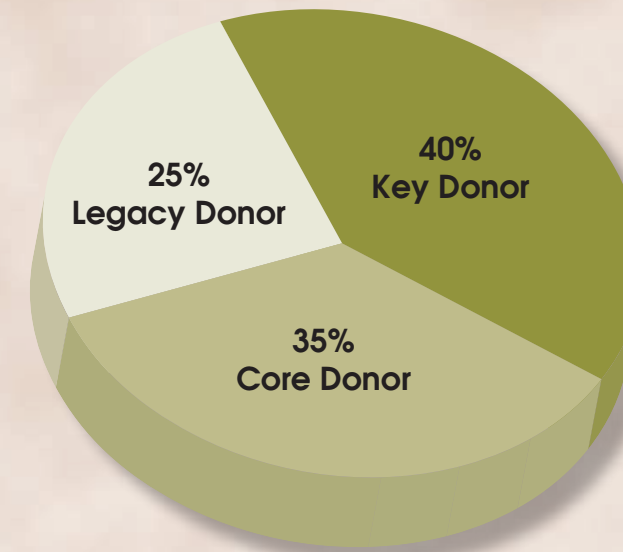
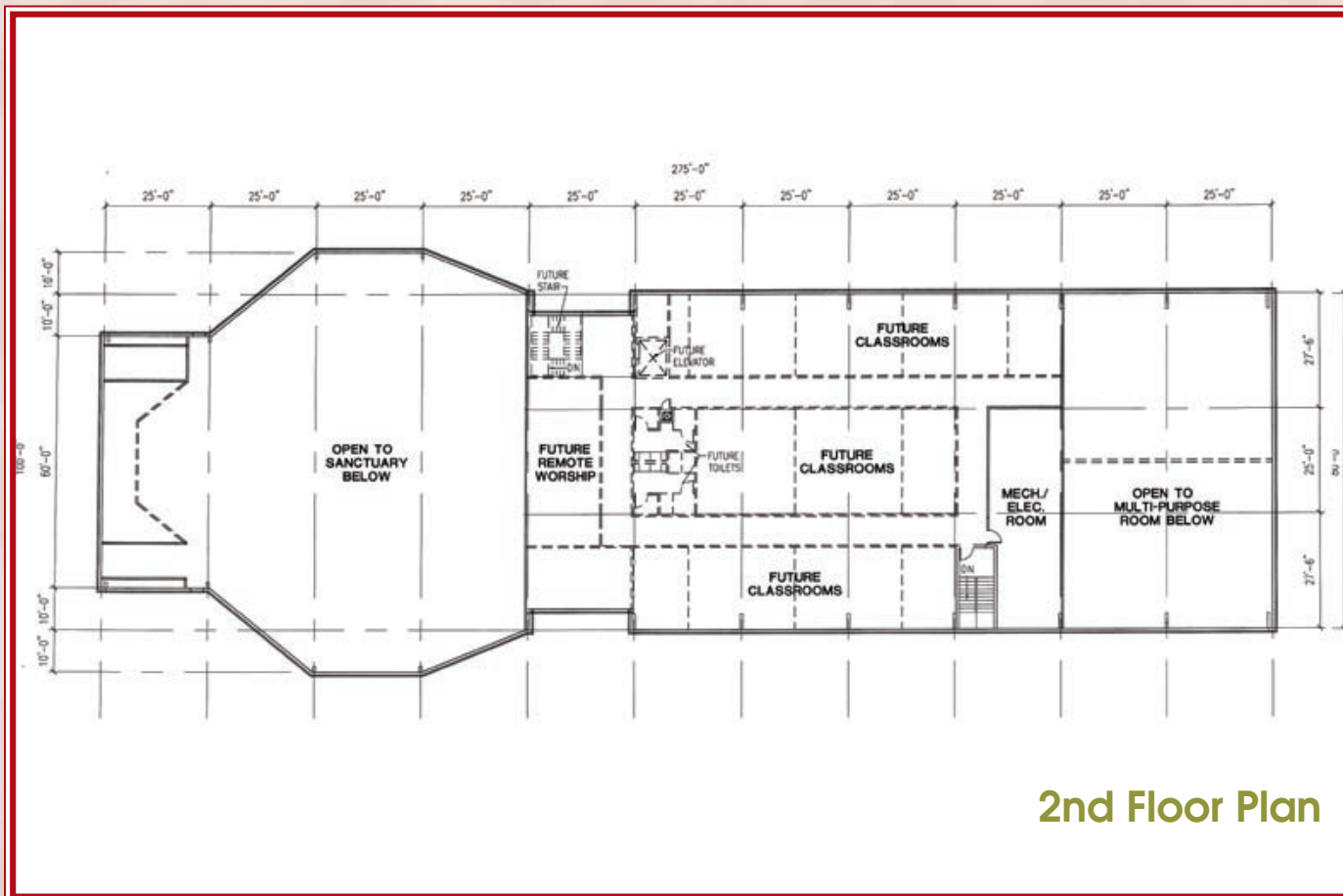
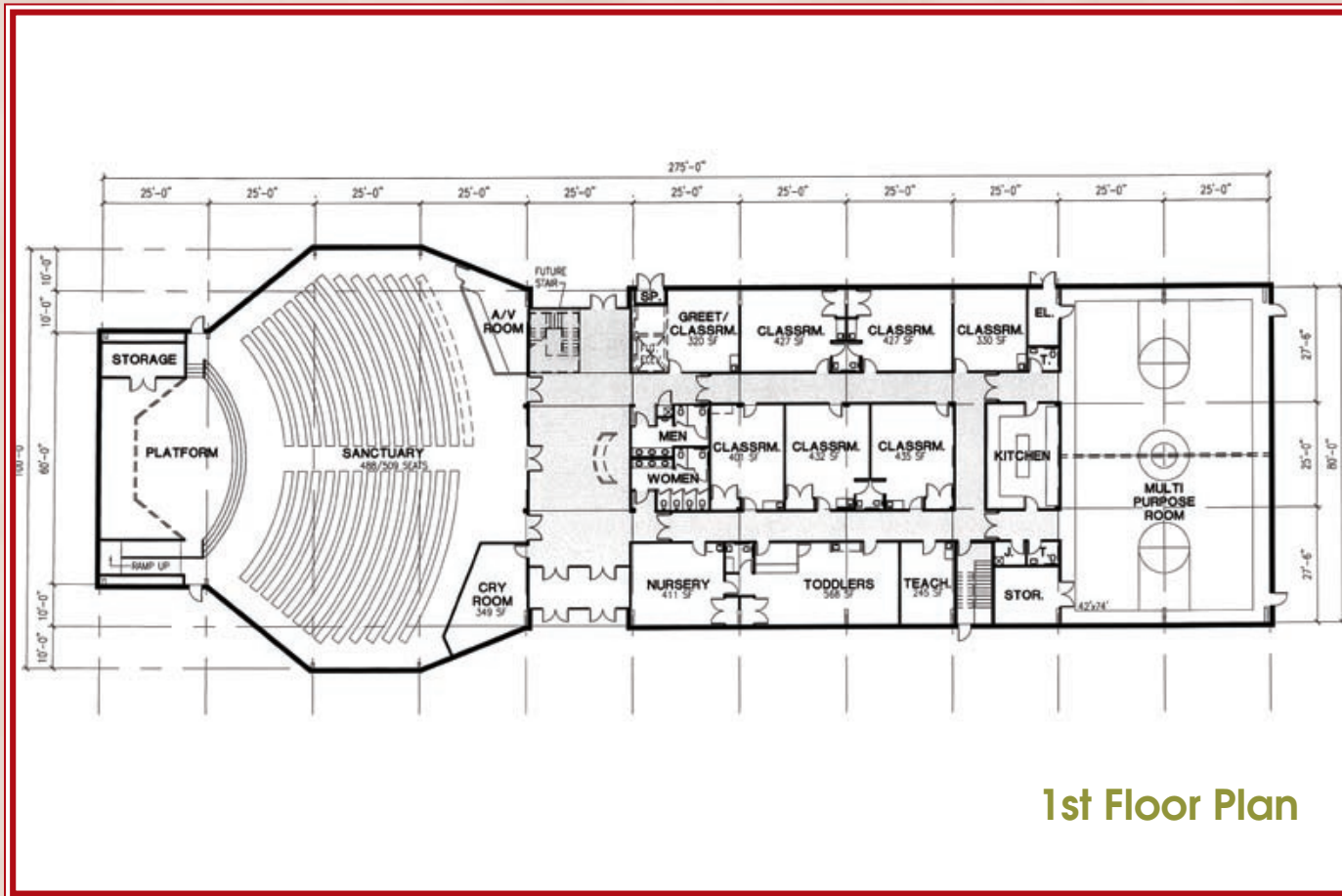

### CORE GIFTS OVER 3 YEARS

Number of Commitments	Giving Amount	Total
100	\$7,000	\$700,000
100		\$700,000

### LEGACY GIFTS OVER 3 YEARS:

Number of Commitments	Giving Amount	Total
1	\$150,000	\$150,000
1	\$125,000	\$125,000
1	\$100,000	\$100,000
1	\$75,000	\$75,000
1	\$50,000	\$50,000
5		\$500,000

### KEY GIFTS OVER 3 YEARS

Number of Commitments	Giving Amount	Total
3	\$40,000	\$120,000
5	\$25,000	\$125,000
5	\$20,000	\$100,000
17	\$15,000	\$255,000
20	\$10,000	\$200,000
50		\$800,000

### FROM THE PASTOR

To my brothers and sisters in Christ,

My hope is that as you read this folder, you will realize what you are holding is not merely campaign literature, but the future of our church.

Look at the floor plans, and I pray that you will see what I see—a home for our vision to be *an Open Door to a Life changing Grace*. This is our opportunity to intentionally build a home where we can genuinely welcome our lost co-workers, neighbors and friends. Here, we can have appropriate space to raise up the next generation, our children, in faith. Here we can worship in our own sanctuary, with no rush to enter or leave. Here in our new home we will be able to fellowship together in a dedicated space, without having to fight through overwhelming traffic. These are just a few things I see as I look at the floor plans. I see a church starting to realize her God given potential.

Read through the vision document, examine the F.A.Q, consider the prayer and pledge cards, and I pray that you will feel as I feel—that this is a critical moment for our church. We have never had our own home, and until we do, we will only continue to chafe against the limitations of space, and resources. This is our time to step up and aim high for the future of our church. If we want to meaningfully live out our calling to be a Gospel centered, Grace-filled church—we need the right space to do it in. Here, finally, is our opportunity.

Only For His Glory,

Pastor Dihan